



Long Meadow Drive , Wickford, SS11 8AX Guide Price £350,000

** GUIDE PRICE £350,000 - £375,000 ** CHAIN FREE **

Situated in the sought-after Long Meadow Drive, Wickford, this refurbished two-bedroom semi-detached bungalow is offered for sale with no onward chain, making it an ideal purchase for first-time buyers or downsizers who just want to move straight in.

The property has undergone modernisation throughout and is presented in excellent decorative order. Recent improvements include complete re-plastering and redecoration, a full rewire, and the installation of a new boiler.

The bright and welcoming accommodation comprises a spacious lounge, two well-proportioned bedrooms with newly fitted carpets, a modern 3-piece shower room, and a stylish fitted kitchen featuring newly installed units, worktops, and oven.

Externally, the property benefits from off-street parking and a lawned front garden which offers excellent potential to create additional driveway space, subject to any necessary permissions. The rear garden provides a pleasant outdoor space for relaxing and entertaining.

Located within easy reach of local amenities, transport links, and Wickford town centre, this turnkey bungalow is ready for immediate occupation and early viewing is highly recommended.

- GUIDE PRICE £350,000 - £375,000
- CHAIN FREE
- TWO BEDROOM SEMI DETACHED BUNGALOW
- POPULAR LOCATION NEARBY WICKFORD HIGH STREET & RAILWAY STATION
- RECENTLY REFURBISHED WITH PLASTERING, DECOR AND CARPETS
- RECENTLY RE WIRED
- NEW BOILER
- NEW KITCHEN
- COUNCIL TAX BAND - BASILDON
- EPC - C

Viewing

Please contact our Sales Office on 01268 730707 if you wish to arrange a viewing appointment for this property or require further information.



Floor Plan

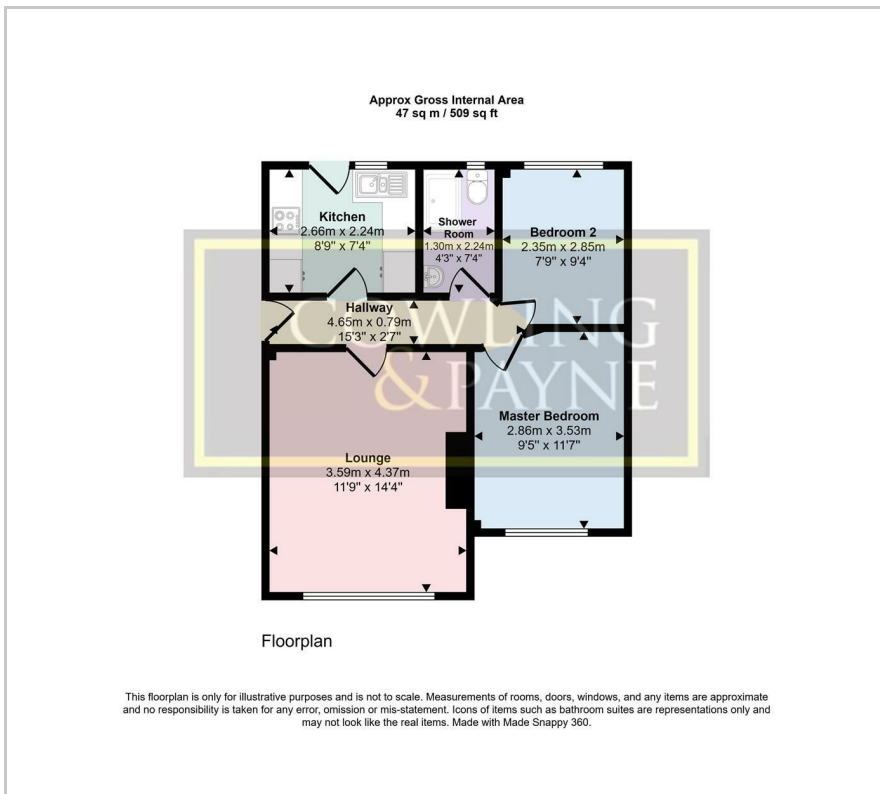

Area Map



Energy Efficiency Graph

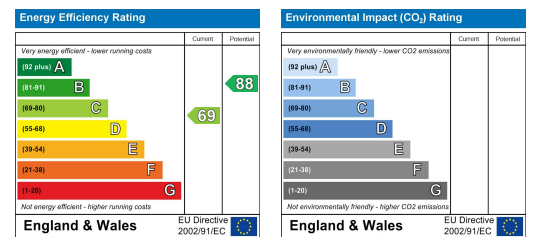

These particulars, whilst believed to be accurate are set out as a general outline only for guidance and do not constitute any part of an offer or contract. Intending purchasers should not rely on them as statements of representation of fact, but must satisfy themselves by inspection or otherwise as to their accuracy. No person in this firm's employment has the authority to make or give any representation or warranty in respect of the property.

2-4 Runwell Road, Wickford, Essex, SS11 7AB

Tel: 01268 730707 Email: info@cowlingandpayne.co.uk <https://www.cowlingandpayne.co.uk>